

Monolithic Insulating Joints, Pipeline Insulating Electrical isolating and cathodic protection



Certification, ISO 10474 3.1 - EN 10204 3.1
Design Code, ASME VIII Div. I - ANSI B31.8

WESTATLANTIC Tech Corp.

www.westatlantictech.com / www.pipelinecoupling.com



sales@westatlantictech.com 902 455 4455

Dielectric Test: 1.5 to 5 KV @ 1 minute AC 50+60 Hz (Special 20 KV @ 1 minute AC 50+60 Hz)

Design temperature: (°C) Standard Application 0 to 90° - Special Application -173 to 180°C

Electric insulation Test: > 200 MΩ @ 1000 Volt DC (Special > 100 GΩ @ 5000 Volt DC)

All Pipe diameters, standard ISO 3183-API 5L - and other specified pipe grades

Design Code: ASME B 31.3 - ASME B 31.4 - ASME B 31.8 - ASME VIII Div.I Appx. 2

Rating: (ASME/ANSI #) Class 150 to 2500 "ANSI/ASA" - 3000 to 15000 "API"

Joint Overall Length: 150 to 12000 (over 3000 insulation joint + extension pipe)

Ends: "BW" Butt Welded: - API 5L / B16.25 / B16.5 / MSS SP75

Connection Pipe: 15 to 3000mm / 1/2" to 120"

Connection Pipe WT: 2.7 to 152.4mm / 0.154" to 6"

Installation: Above ground / underground / sub sea

Design pressure: (BarG) 6 to 1034.5

TYPICAL API 300# Drawing

WESTATLANTIC Tech Corp.

www.pipelinecoupling.com / sales@westatlantictech.com + 902 455 4455

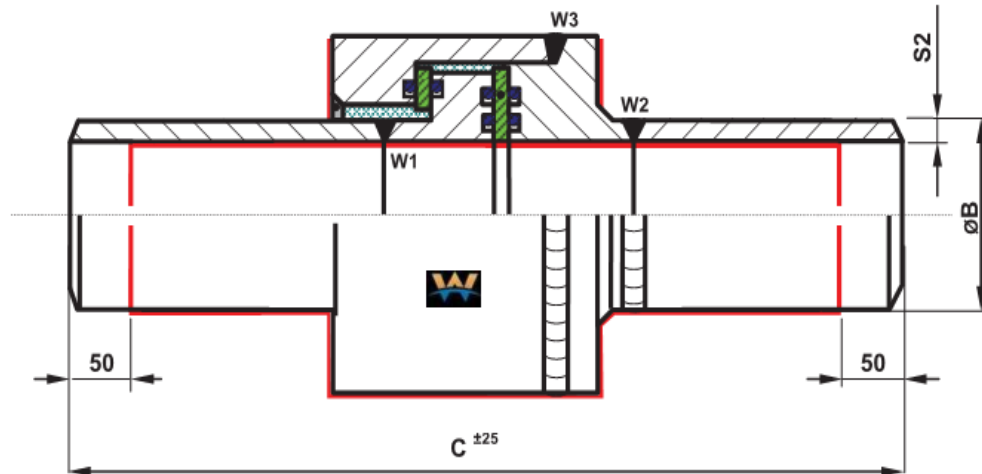

DN inch	ANSI API	Ø B (mm)	C (mm)	S 2 (mm)	PUP API	DP (Barg)	TP (Barg)	Item
6"	300#	168.3	700	7.11	X42	50	75	#04
STANDARD JOINT SPECIFICATION				NON DESTRUCTION TESTING (NDT)				
Design Temperature(°C)	-10	+ 120	Pipe Ring Weld (W1-W2)	MT☑	UT☑			
Electric Resistance (MΩ)	> 200	1000 V. DC	Closing Weld (W3)	MT☑	UT☑			
Dielectric Strength (kV)	5 AC 50 Hz	Duration 1'	Weld end Bevels	MT☑	UT☑			

Ph 902 455 4455



No loss of integrity due to thermal expansion or ground stress as is common with flange isolation gasket kits. Tested hydraulically and electrically to 1½ times the design pressure.

Maintenance free, reliable cathodic isolation of equipment in required strategic applications.

Isolate stray currents from outer forces such as electrical transmission systems and earth currents.

Excellent bending and torsion resistance.