

Seal pipe through walls that have water hammer forces along the pipeline.

WA-GPPLR pipe seals

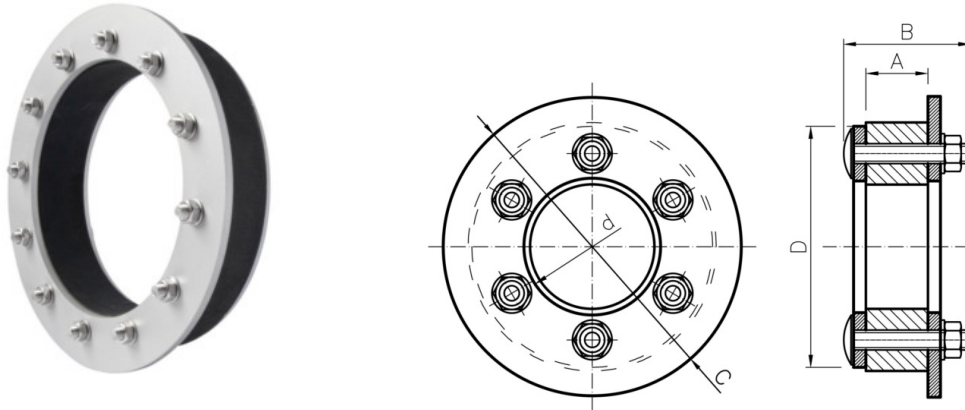

WA-GPPLR pipe seals has one of the plate rings enlarged for anchoring the seal against hammer shock.

The larger ring is installed on the inflow side.

The enlarged ring design also provides security of the seal from dropping into the opening on a vertical mounted pipe.

ADVANTAGES:

Seals are made to order, "made to measure".

Provides watertight seals up to 36 psi

Protects against migration of liquids, gases and smoke.

Dampens vibrations and noise

Angular deviation of the pipeline axis from the hole axis cannot exceed 2 °.

Split version for existing pipe, cable, etc.),

Resistance to high water hammer.

HOW TO ORDER:

Inner diameter of the casing pipe or hole [mm or inches]

Outer diameter of the service pipe [mm or inches]

Material of the seals - EDPM, NBR, Silicone.

Split (for sealing existing pipes / or non-split)

www.westatlantictech.com - +1 902-455 4455
sales@westatlantictech.com