

Fits all American pipe sizes. Each saddle fits a range of outside diameters for a given pipe size.

WESTATLANTIC Tech Corp., Ductile Iron Tapping saddles. Hot taps on existing pipelines.

### for water and gas pipes

#### Characteristics of the DTS saddle

- Solid, well thought-out construction.
- High quality GGG 50 ductile iron.
- Produced according to DIN 3543, Part 1.
- Saddle is provided with epoxy coating, EWS epoxy according GSK-diridives RAL-G2-662 DVGW-W-270, which prevents rust.
- DVGW (G87 e 087) approved.
- Perfect seal through flat O-ring, which is enclosed in the chamber of the alignment saddle (see illustration). Through a special combination of O-ring and flat ring, a two-fold seal is obtained. Rubber for ring gasket is NBR.
- Applicable for various types of material, such as asbestos-cement, cast iron and steel.
- Very suitable for pipes covered with polyethylene. When Westatlantic DTS Saddles are placed, the polyethylene layer does not have to be removed. Test report upon request.
- Wide, 100% stainless steel lower bracket.
- Lower bracket provided with a special rubber band.
- Stainless steel, electrolytic zinc plated nuts, to prevent fretting.
- Saddles available from DN 40 up to including DN 600.
- Suitable for alignments under pressure.



#### Applications

**Ductile Iron** DTS Saddle can be used to make taps on all pipe types except PE for water and gas applications.

This saddle is ideal for pipes covered with polyethylene, but also fits old pipes perfectly.

#### Dimensions

- **Ductile Iron** DTS Saddle can be supplied with a tapped service outlet of 1/2" up to and including 2".
- Special service outlets are available upon request.
- **Westatlantic Ductile Iron** can be supplied from DN 40 up to and including DN 600. Strap width 60 mm
- Also available with branch according to Polva 1 1/2" to 2".

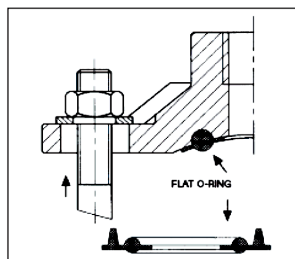
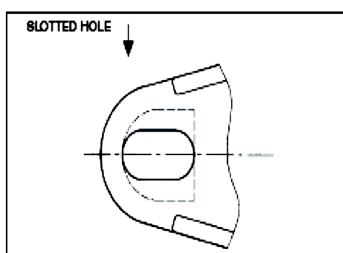

DN in mm	Working Range
40	44-57
50	58-72
60	72-82
80	82-102
80	88-108
100	106-130
125	129-158
150	159-186
175	184-210
200	211-244
225	235-255
250	264-298
300	315-358
325-600	On Request

**WESTATLANTIC Tech Corp.** [www.westatlantictech.com](http://www.westatlantictech.com) / [www.pipelinecoupling.com](http://www.pipelinecoupling.com)  
[sales@westatlantictech.com](mailto:sales@westatlantictech.com) + 902 455 4455